



## Welcome!

The ISPN Board of Directors and the Conference Committee welcome you to our **26th Annual Conference**, entitled **Psychiatric Mental Health Nurses: The Power of Leading, Connecting, and Healing**. This conference will allow connecting, learning, networking, socializing, and so much more. ISPN is an exceptional organization specifically for advanced psychiatric mental health nurses and students - we believe you will truly thrive in this year's program content. We offer a wide range of presentations that fall into the broad categories of education/teaching pedagogy, evidence-based practice, research, psychopharmacology, and leadership in the United States and abroad. We are grateful to have world-renowned speakers who are experts in psychiatric mental health nursing and issues related to our conference.

In addition to the learning, we want you to get up and move in the morning, join our yoga class run by Briana Snyder, go shopping, sight see, come to the Relaxation Room for some aromatherapy or a hand massage, or to unwind. Consider the following opportunities:

- Pre-Meeting Workshop
- Opening Reception
- New Member and Student Breakfast
- Product Theaters
- Vendors
- IMIN-ISPN Mentoring Initiative
- Foundation Event
- International Meet and Greet
- Student Event
- Regional Meetings

We view the Annual ISPN Conference as a time of renewal and growth, a way to initiate and strengthen professional relationships, and a forum for ideas to advance our profession and discipline.

As we reflect on the unique opportunities available to members and guests of the International Society of Psychiatric-Mental Health Nurses Annual Conference, we are proud to stand behind the mission of the organization: to support advanced-practice psychiatric-mental health nurses in promoting mental health care, literacy, and policy worldwide. We encourage you to reflect on how your lifework aligns with this mission.



We are grateful to the members of the Conference Committee and the staff at The Rees Group, who have contributed beautiful ideas, recruited fabulous speakers, and worked tirelessly to offer this Conference. We wish you all the best.

### Enjoy!

Gabrielle P. Abelard, DNP, PMHNP,  
PMHCNS-BC, APRN, FNAP, FAAN  
Conference Committee Chair

## Table of Contents:

Abstract Reviewers .....	3
Awards.....	5
Business Meeting .....	5
Committees.....	2
Conference Objectives.....	3
Evaluation Survey .....	5
Exhibitors.....	5
Foundation Board.....	2
Foundation Donors .....	5
Foundation Event.....	4
Meeting Room Floor Plan .....	8
Mission and Practices .....	2
New Member and Student Breakfast .....	4
Nursing Contact Hours.....	3
Officers and Directors.....	2
Product Theaters .....	4
Poster Sessions.....	4 & 16
Program.....	9
Wednesday.....	9
Thursday.....	10
Friday.....	12
Saturday.....	15
Sponsors and Advertisers.....	7 & 18
Student Event.....	5
Welcome .....	1

## ISPN Mission and Vision

### Mission:

To promote advanced psychiatric-mental health nursing leadership in practice, research, education, and policy worldwide.

### Vision:

ISPN will be the premier, global psychiatric-mental health nurses' organization.

## General Information

### Officers & Directors

#### PRESIDENT

Shawn Gallagher, PhD, PMHNP-BC, PMHCNS-BC, FNP-BC

#### PRESIDENT-ELECT

Barbara Peterson, PhD, PMHCNS-BC, APRN, FNAP

#### TREASURER

Sara J. Edmund, DNP, RN, FNP-C, PMHNP-BC

#### PAST PRESIDENT

Ukamaka M. Oruche, PhD, RN, PMHCNS-BC, FAAN

#### DIRECTORS

Rhonda Schwindt, DNP, PMHNP-BC  
Stephanie Wynn, DNP, RN-BC, PMHNP-BC, FNP-BC, FAANP, FNAP

#### RECORDING SECRETARY

Julie Bertram, PhD, RN

#### ISPN EXECUTIVE DIRECTOR, EX OFFICIO

Jessica Retzlaff

### ISPN Foundation Board

#### PRESIDENT

Karan Kverno, PhD, PMHNP-BC, PMHCNS-BC

#### PAST PRESIDENT

Dan Wesemann, DNP, PMHNP-BC, ARNP

#### PRESIDENT-ELECT

Brayden Kameg, DNP, PMHNP-BC, CARN, CNE

#### SECRETARY

Emily Sinnwell, DNP, ARNP, FNP-BC, PMHNP-BC

#### TREASURER

J. Kaye Knauff, DNP, RN, FNP-BC, PMHNP-BC

#### BOARD MEMBERS

Cynthia Handrup, DNP, APRN, PMHCNS-BC

Catherine Kane, PhD, RN, FAAN

Marian Newton, PhD, RN, CS, PMHNP, ANEF

Fatima Ramos-Marcuse, PhD, PMHNP-BC

### ISPN Committees

#### AWARDS COMMITTEE CHAIR

Rhonda Schwindt, DNP, PMHNP-BC

#### COMMUNICATIONS & MARKETING COMMITTEE CHAIR

Steven Prymachuk, PhD, PGDipEd, RN (Mental Health), CPsychol, SFHEA

#### CONFERENCE COMMITTEE

Gabrielle P. Abelard, DNP, PMHNP, PMHCNS-BC, APRN, FNAP, FAAN

#### DIVERSITY, EQUITY AND INCLUSION COMMITTEE

Shaquita Starks, PhD, APRN, PMHNP-BC, FNP-BC  
Frieda Outlaw, PhD, RN, APRN, FAAN

#### FINANCE COMMITTEE CHAIR

Sara J. Edmund, DNP, RN, FNP-C, PMHNP-BC

#### MEMBERSHIP COMMITTEE CHAIR

Dina (Fradkin) Veytsman, DNP, CNP/APRN, PMHNP-BC  
Mary Louise Tatum, MNP-BC

#### NOMINATING COMMITTEE CHAIR

Ukamaka M. Oruche, PhD, RN, PMHCNS-BC, FAAN

#### POLICY COMMITTEE

Pamela Galehouse, PhD, RN, PMHCNS, CNL

#### NEWSLETTER EDITOR

Brayden Kameg, DNP, PMHNP-BC, CARN, CNE

## Conference Committee

Chair: Gabrielle P. Abelard, DNP, PMHNP, PMHCNS-BC, APRN, FNAP, FAAN

Stephanie DesRoches, DNP, PMHNP-BC  
Susan Glodstein, DNP, RN, PMHNP-BC, PMHCNS-BC  
Wanda Hilliard, DNP, MBA, PMHNP  
Yesol Hong, MSN, RN, AANP-FNC  
Ann Marie Jones, DNP, PMHNP-BC  
Karan Kverno, PhD, PMHNP-BC, PMHCNS-BC, FAANP, FAAN  
Meghann Postgate, APRN, PMHNP-BC  
Fatima Ramos-Marcuse, PhD, PMHNP-BC  
Briana Snyder, PhD, RN, PMH-BC, CNE, RYT 200  
Kimberly Stack, DNP, PMHNP-BC  
Christopher Tersigni, MSN, RN, PMH-BC, CNE  
Robi Thomas, PhD, RN, PMHNP-BC  
Sharon Ward-Miller, DNP, MA, RN, PMHCNS-BC  
Shawna Witt, BSN, RN

Board Liaison: Barbara Peterson, PhD, PMHCNS-BC, APRN, FNAP

## Abstract Reviewers

Thank you to all who served as abstract reviewers for this year's program. We appreciate your involvement!

Elizabeth Bonham, PhD, RN, PMHCNS-BC, FAAN  
Kim Butts, DNP, MSN-Ed, RN, PMH-BC  
Rie Chiba, RN, PhD  
Elaine Darst, PhD, APRN, PMHCNS-BC, RN  
Stephanie DesRoches, DNP, PMHNP-BC  
Pamela Galehouse, PhD, RN, CNL, PMHCNS  
Susan Glodstein, DNP, RN, PMHNP-BC, PMHCNS-BC  
Jennifer Graber, EdD, APRN, PMHCNS-BC  
Lexxie Gramke, PhD, PMHNP-BC, AGPCNP-BC  
Heather Harvey, RN, BSN  
Wanda Hilliard, DNP, MBA, PMHNP  
Michaela Hogan, DNP, APRN, PMHNP-BC, CNE  
Pam Laskowski, RN, PhD, CNE  
Sarah Oerther, PhD, MEd, RN, FNP-BC, ANEF  
Meghann Postgate, APRN, PMHNP-BC  
Nicole Price, MSN, APRN, CEN, PMH-BC, NP-BC  
JoEllen Schimmels, PhD, DNP, RN, PMHNP-BC, CNE, FAAN  
Briana Snyder, PhD, RN, PMH-BC CNE, RYT 200  
Allison Stafford, PhD, RN  
Robi Thomas, PhD, RN, PMHNP-BC  
Sharon Ward-Miller, DNP, MA, RN, PMHCNS-BC  
Dan Wesemann, DNP, MSW, PMHNP, ARNP  
Shawna Witt, BSN, RN  
Jaclene Zauszniewski, PhD, RN-BC, FAAN

## Conference Objectives

At the end of this Conference, the participant should be able to:

- Implement two techniques or exemplars into curriculum and/or educational programs.
- Apply evidence of two psychiatric-mental healthcare research and innovations into practice.
- Identify two approaches and/or tools that psychiatric mental health nurses can leverage AI technologies to influence decision-making, enhance patient monitoring, personalized care, and navigate ethical considerations.
- Evaluate two leadership and policy strategies that address health equity, reduction of health disparities, and include vulnerable populations.
- Discuss two significant trends related to the roles of psychiatric mental health nurses practice including the role of the psychiatric mental health nurse practitioner, clinical nurse specialist, and nurse psychotherapist.
- Identify two approaches and or tools that psychiatric mental health nurses can leverage to prioritize personal well-being to cultivate resilience.
- Implement one to two psychotherapy techniques in practice with your treatment population.
- Utilize two psychopharmacological/integrative health evidence-based practice changes to incorporate into clinical practice that improve individual and population health, while reducing mental health disparities across the lifespan.

## Nursing Contact Hours

ISPN has applied for contact hours from the Georgia Nurses Association, an accredited approver by the American Nurses Credentialing Center's Commission on Accreditation.

Information about credits will be announced on the ISPN website closer to the meeting dates.



## Mobile App

Download the **WHOVA mobile app** for the Annual Conference! An email was sent to all registered attendees with access information. Be sure to spend time exploring the many options and information provided by the mobile app.

- View each day's full schedule.
- Add sessions to your personalized calendar.
- Find social events, student activities, business meetings, and much more.
- See a list of other attendees so you can plan your time in Providence with friends and colleagues. Click an attendee name to find out more about them, say hello, send a message, or suggest a meeting time.
- Use the Community function as the techno version of a bulletin board.
- Post meet-ups, restaurant reviews, lost and found, and much more.
- Check out the exhibitors, make appointments to meet them, send representatives a message.
- Share your photos of Providence!

## Poster Sessions

Posters will be available for viewing in the Narragansett Ballroom B.

### Poster Setup Time:

Wednesday, April 3: 5:30 p.m.-6:30 p.m.

### Presentation Time:

Wednesday, April 3: 6:30 p.m.-8:00 p.m.  
(Opening Reception, Authors Present)

### Poster Viewing Time:

Thursday, April 4: 9:30 a.m.-4:00 p.m.

Friday, April 5: 9:30 a.m.-3:30 p.m.

### Poster Teardown Time:

Friday, April 5: 3:30 p.m.-4:00 p.m.

ISPN will not keep any poster presentations that are not dismantled on Friday, April 5 between 3:30 p.m.-4:00 p.m. Please plan to retrieve your poster.

## New Member and Student Breakfast

Thursday, April 4, 2024  
7:30 a.m.-8:30 a.m. | South County Room (3rd Floor)

**Calling all new members and students!** This is the perfect opportunity to ask questions and meet the ISPN and Foundation Boards of Directors. And to meet each other! Please join us.

## ISPN Foundation Event

Enjoy an evening of great food, camaraderie, and the chance to bid on numerous silent and live auction items. The event runs from 7:00-9:00 p.m. on Thursday, April 4th. Funds raised will support the ISPN Historical Archiving initiative.

This year's theme is "**Healing Through Connections.**" You're encouraged to bring an item to donate to the auction. Think about not only items, but experiences as well! Donations can be dropped off at the ISPN Foundation table near registration on Wednesday, April 3rd. [Click here](#) for the Auction Donation Form to bring along with your item(s).

Foundation event tickets can be purchased with your conference registration. A limited number of tickets may be purchased on site.

The Foundation is also hosting a raffle, which concludes on Friday at the start of the Annual Business Meeting. Winners will be announced at the meeting.



## Product Theater Events

Thank you to the following companies for sponsoring product theaters this year!

Thursday, April 4, 2024

12:15 p.m.-1:15 p.m. | Narragansett Ballroom A (1st Floor)

### Product Theater Luncheon Sponsored by Neurocrine Biosciences

Tardive Dyskinesia: Clinical Insights into Differential Diagnosis and Evidence-Based Treatment Strategies

Daniel E. Wesemann, DNP, MSW, RN, APRN, PMHNP-BC  
University of Iowa



Friday, April 5, 2024

7:15 a.m.-8:15 a.m. | Narragansett Ballroom A (1st Floor)

### Product Theater Breakfast Sponsored by Karuna Therapeutics

Rethink Schizophrenia  
Desiree Matthews, PMHNP-BC  
Different MPH



Friday, April 5, 2024

12:15 p.m.-1:15 p.m. | Narragansett Ballroom A (1st Floor)

### Product Theater Luncheon Sponsored by Neurocrine Biosciences

The Impact of Tardive Dyskinesia: The Data and a Patient Story  
Amy LaCouture, RN, BSN, PMHNP-BC

Synergy Behavioral Health LLC/NHS FACT/ACT Team

Bethany  
Patient Ambassador



## Get to Know Your Fellow Attendees

We encourage all to get to know as many new colleagues as possible. Stickers will be provided at the ISPN registration desk. Share a sticker with a new connection during the Annual Conference. Place stickers you have exchanged on the back of the your conference badge for safekeeping.

The person with the greatest number of stickers collected will win a \$50 visa card! Have a blast getting know as many colleagues as possible.

## Take and Share Your Photos

Stop by the Photo Booth table (located in the exhibit area) with your cell phone for fun selfies and to take photos with peers. Be sure to share them on the WHOVA mobile app or on the ISPN social media channels.

As you explore Providence, post your photos and recommendations on the WHOVA mobile app to share with fellow attendees.

## Student Event

Friday, April 5, 2024  
7:30 p.m.-9:00 p.m. | South County Room (3rd Floor)  
Student Event

**Calling all students!** The ISPN Membership Committee is pleased to host this session, where members will share information about the benefits of the IMIN Mentoring Program, as well as talk about how to get more involved in ISPN, meet other students, and discover what ISPN can do for you.

## Evaluation Survey

The program evaluation survey will be sent to your email address on file. Please complete and submit your evaluation form electronically. Your comments are valuable to ISPN and assist the Conference Committee in planning future events.

## Business Meeting

ISPN will hold its Annual Business Meeting on Friday, April 5, from 1:30 p.m.-3:00 p.m. in Narragansett Ballroom A. All members are encouraged to participate in this annual governance meeting, where the ISPN Board will discuss the Society's business report, including the strategic plan. Please be sure to attend!

## Awards Ceremony

The annual presentation of awards will honor the achievements of your colleagues in numerous areas during the Awards Ceremony on Friday, April 5 immediately following the Business Meeting. Please join your friends and colleagues in recognizing those who have demonstrated outstanding achievement and leadership in the psychiatric and mental health field.

## Non-Endorsement of Products

The presence of commercial exhibits during the conference does not imply the endorsement by the ISPN, Georgia Nurses Association or the American Nurses Credentialing Center's Commission on Accreditation.

## Thank You Foundation Donors!

Cheryl Desmarais	Pamela Minarik
Judith Fry-McComish	Marian Newton
Pam Galehouse	Chinelo Onwuazombe
Heather Harvey	Nicole Price
Noah Hendler	Deborah Sandella
Vicki Hines-Martin	Kathleen Scharer
Don Howe	Rachel L. Thomas
Judith Jarosinski	Nicole Walters
Merrie Kaas	Dara Yastrzemski
Catherine Kane	Edilma Yearwood
Patty Mares Miller	

## Exhibitors

Plan time in your schedule to visit the exhibiting companies in the Narragansett Ballroom B. Refreshment breaks will be held there each day.

Wednesday, April 3	6:30 p.m.-8:00 p.m. (Opening Reception)
Thursday, April 4	9:30 a.m.-4:00 p.m.
Friday, April 5	9:30 a.m.-3:30 p.m.

### AbbVie Pharmaceuticals

**Booth 1**

#### Platinum Sponsor

Email: [danialo@abbvie.com](mailto:danialo@abbvie.com)

Website: [abbvie.com](http://abbvie.com)

AbbVie's mission is to discover and deliver innovative medicines that solve serious health issues today and address the medical challenges of tomorrow. We strive to have a remarkable impact on people's lives across several key therapeutic areas. Please visit [abbvie.com](http://abbvie.com).

### Alkermes

**Booth 3**

Email: [karen.holmes@alkermes.com](mailto:karen.holmes@alkermes.com)

Website: [alkermes.com](http://alkermes.com)

### American Academy of Nurse Practitioners Certification Board

**Booth 9**

#### Gold Sponsor

Email: [ebusk@aanpcert.org](mailto:ebusk@aanpcert.org)

Website: [aanpcert.org](http://aanpcert.org)

AANPCB provides excellence in NP testing and certification. We offer competency-based examinations in family, adult-gerontology primary care, psychiatric mental health, and emergency care. AANPCB also provides renewal processes for the FNP, AGNP, PMHNP, ENP, ANP, and GNP.

**American Nurses Credentialing Center**Email: [tony.ward@ana.org](mailto:tony.ward@ana.org)Website: [nursingworld.org/ancc](http://nursingworld.org/ancc)**Booth 7**

ISPN members get \$55 off initial or certification renewals:

1) Psychiatric-Mental Health Nurse Practitioner (Across the Lifespan) and 2) Psychiatric-Mental Health Nursing certifications. Learn more about our team as we are here to help you: [nursingworld.org/advanced-practice/meet-the-team](http://nursingworld.org/advanced-practice/meet-the-team)

**Banyan Treatment Centers**Email: [christina.chadwick@banyancenters.com](mailto:christina.chadwick@banyancenters.com)Website: [banyantreatmentcenter.com](http://banyantreatmentcenter.com)**Booth 14**

At Banyan Treatment Centers, we offer addiction treatment and residential mental health programs to address co-occurring disorders and mental health needs. Whether a patient is facing substance abuse, mental illness, or both, we are here to provide comprehensive treatments to make healing a possibility.

**Bradley Hospital**Email: [marianne.pyliotis@lifespan.org](mailto:marianne.pyliotis@lifespan.org)Website: [bradleyhospital.org](http://bradleyhospital.org)**Booth 15**

Founded in 1931, Bradley Hospital, a teaching hospital for The Warren Alpert Medical School at Brown University, was the nation's first psychiatric hospital exclusively for children. Today, it provides expert, family-focused care to children and adolescents with psychological, developmental and behavioral problems through a wide range of inpatient, outpatient, residential and partial hospital programs.

**Castle Biosciences****Bronze Sponsor**Email: [jpowers@castlebiosciences.com](mailto:jpowers@castlebiosciences.com)Website: [castlebiosciences.com](http://castlebiosciences.com)**Booth 8**

Stop by to learn more about IDgenetix, a pharmacogenomic test to guide medications and dosing for mental health diagnoses.

**Children's Hospital of Philadelphia****Platinum Sponsor**Email: [steinmiller@chop.edu](mailto:steinmiller@chop.edu)Website: [chop.edu](http://chop.edu)**Booth 10**

Every day at Children's Hospital of Philadelphia, we provide the best, most innovative care for children and adolescents. Our state-of-the-art facilities include our brand-new Behavioral Health & Crisis Center, which features inpatient psychiatric beds and a 24/7 crisis response center.

**Elaine Marieb College of Nursing  
University of Massachusetts, Amherst**Email: [kayotte@nursing.umass.edu](mailto:kayotte@nursing.umass.edu)Website: [umass.edu/nursing](http://umass.edu/nursing)**Booth 11**

Stop by to learn more about the College of Nursing Masters and DNP Program Overview.

**Futures Recovery Healthcare****ISPN Foundation Sponsor**Email: [admissions@futuresrecoveryhealthcare.com](mailto:admissions@futuresrecoveryhealthcare.com)Website: [futuresrecoveryhealthcare.com](http://futuresrecoveryhealthcare.com)**Booth 2**

Futures Recovery Healthcare offers comprehensive detox, residential, and outpatient programs for substance abuse, co-occurring conditions, and mental health diagnoses. Specialized offerings include Orenda Concierge, Rise Experiential, and Hero's Ascent for Veterans, First Responders, and Healthcare professionals. With expertise in trauma and chronic pain, Futures prioritizes individualized, compassionate care, integrating family support and active alumni engagement for ongoing wellness.

**Intra-Cellular Therapies**Email: [jlennon@itci.com](mailto:jlennon@itci.com)Website: [intracellulartherapies.com](http://intracellulartherapies.com)**Booth 4**

Intra-Cellular Therapies is a biopharmaceutical company founded on Dr. Paul Greengard's Nobel Prize-winning research that uncovered how therapies affect the inner-working of cells in the body. We leverage this intracellular approach to develop innovative treatments for people living with complex psychiatric and neurologic diseases. To request samples or schedule a meeting with a neuroscience sales specialist, call today - 888-252-4824!

**Janssen**Email: [jlennon@itci-inc.com](mailto:jlennon@itci-inc.com)Website: [janssen.com](http://janssen.com)**Booth 17**

Janssen Neuroscience promoting our long acting injectable medication that can be taken once a month, quarterly or two times a year!

**Lifespan**Email: [mkenneyhill@lifespan.org](mailto:mkenneyhill@lifespan.org)Website: [lifespan.org](http://lifespan.org)**Booth 12****McLean Hospital****Bronze Sponsor**Email: [krhuda1@partners.org](mailto:krhuda1@partners.org)Website: [mcleanhospital.org](http://mcleanhospital.org)**Booth 5**

Top-ranked by U.S. News & World Report, McLean Hospital puts people first in mental health. Offering unparalleled treatment services for children and adults living with conditions including depression, borderline personality disorder, PTSD, and addiction, McLean also hosts regular trainings for psychiatric nurses and other health care professionals.



## Neurocrine Biosciences

### Platinum Sponsor

Email: [acahoon@neurocrine.com](mailto:acahoon@neurocrine.com)

Website: [neurocrine.com](http://neurocrine.com)

Neurocrine Biosciences is a leading neuroscience - focused, biopharmaceutical company with a simple purpose: to relieve suffering for people with great needs, but few options. We are dedicated to discovering and developing life-changing treatments for patients with under-addressed neurological, neuroendocrine, and neuropsychiatric disorders.

## Otsuka America Pharmaceutical

Booth 13

Email: [Christopher.Okiwe@otsuka-us.com](mailto:Christopher.Okiwe@otsuka-us.com)

Website: [Otsuka-us.com](http://Otsuka-us.com)

ABILIFY MYCITE, a drug-device combination product comprised of aripiprazole tablets embedded with an Ingestible Event Marker (IEM) sensor intended to track drug ingestion.

## Provincial Health Services Authority (PHSA) Booth 16

Email: [ravanjeet.dosange@phsa.ca](mailto:ravanjeet.dosange@phsa.ca)

Website: [phsa.ca](http://phsa.ca)

PHSA plans, coordinates, and evaluates specialized health services with BC health authorities, ensuring equitable and cost-effective healthcare province-wide. Collaborating with professionals, it improves access to evidence-based practice, promotes health, manages chronic conditions, and emphasizes prevention for effective healthcare delivery to residents.



Booth 6

## Sponsors

Thank you to the sponsors of the 2024 ISPN Annual Conference!

### Platinum Sponsors

abbvie

 Children's Hospital  
of Philadelphia®

 KARUNA  
THERAPEUTICS

 NEUROCRINE®  
BIOSCIENCES

### Gold Sponsors

 AMERICAN of ACADEMY  
NURSE PRACTITIONERS  
CERTIFICATION BOARD

### Bronze Sponsors

 C/STLE  
BIOSCIENCES

  
GLOBAL  
ALLIANCE  
*for Behavioral Health  
and Social Justice*

 McLean  
HARVARD MEDICAL SCHOOL AFFILIATE

### ISPN Foundation Sponsor

 FURES  
RECOVERY HEALTHCARE

# Hotel Meeting Room Floor Plans

### Providence (Ground Floor)

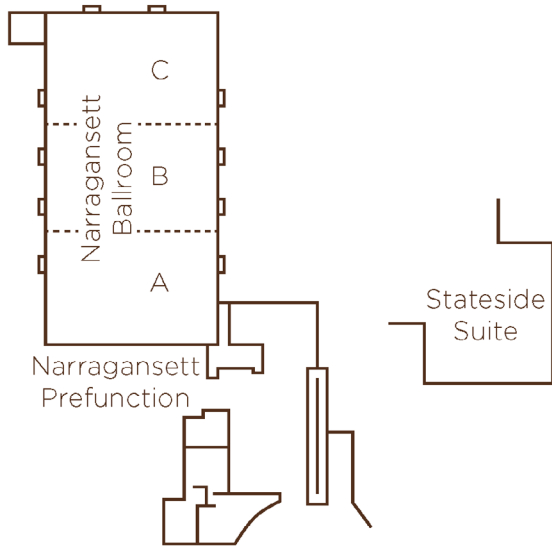

### Providence Rotunda (Second Floor)

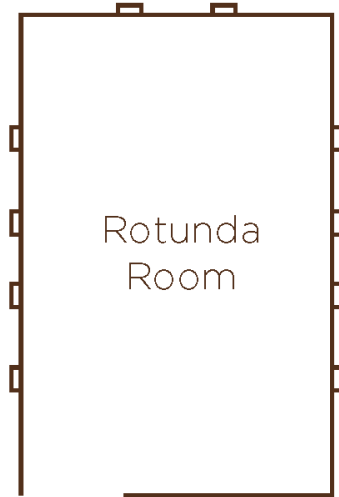

### Providence (Second Floor)

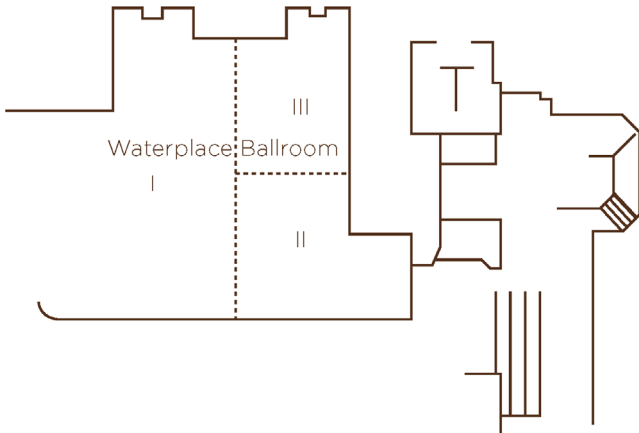

### Providence (Third Floor)

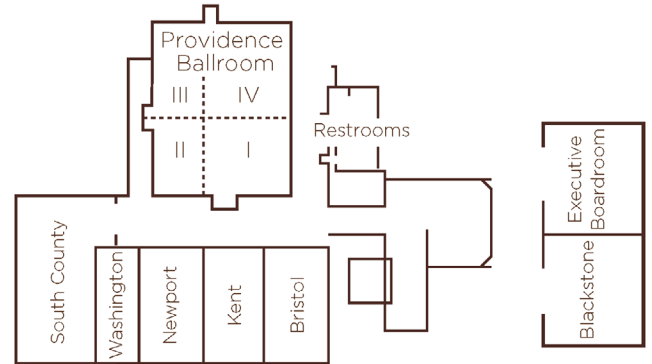





# PROGRAM

**Wednesday, April 3, 2024**

12:00 p.m.-7:00 p.m. | Narragansett Ballroom Foyer (1st Floor)  
**Registration Open**

1:00 p.m.-5:00 p.m. | Providence Ballroom I (3rd Floor)  
**Pre-Meeting Workshop: Psychiatric Mental Health Nurses:  
The Power of Understanding and Leading Holistic Care for  
Individuals Diagnosed with Autism Spectrum Disorder**  
(Available at an additional fee)



**Lauren Frederick,**  
MA, BCBA,  
Autism New  
Jersey



**Anne Kearney,**  
MSN, CRNP,  
PMHNP-BC,  
Children's  
Hospital of  
Philadelphia

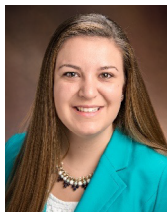

**Jessica McCurry,**  
MSN, APRN,  
PMHNP-BC,  
Bradley Hospital



**Elizabeth Steinmiller,**  
MSN, PMHCNS-  
BC, Children's  
Hospital of  
Philadelphia

Often psychiatric nurse practitioners are asked to prescribe medications to impact disruptive behavior in individuals diagnosed with autism spectrum disorder (ASD). While there is an evidence-base to support addressing underlying causes of functional impairment, such as anxiety or rigidity, psychotropic medication alone is neither indicated nor sufficient. There is more to consider about the patient's environment and community involvement when discerning treatment needs. For example, children with ASD have specialized educational supports, multi-disciplinary team members and often are receiving Applied Behavior Analysis (ABA) therapy. Many do know that a behavioral clinician could help inform prescribing decisions. Additionally, providers may not know the various legal and regulatory guidelines that are in place to ensure these patients' rights are met and supported.

Individuals diagnosed with ASD also have higher rates of medical co-morbidities, more unmet healthcare needs, lower satisfaction with healthcare interactions, and higher mortality rates than the general population. Many autistic individuals have complex medical and psychiatric needs but struggle to find compassionate, high quality and effective care. This workshop will discuss the common characteristics and co-morbidities among autistic individuals leading to their need for increased healthcare.

Workshop participants will learn how to integrate autism friendly practices into medical and psychiatric patient care. Participants will also gain a greater understanding of how other autism service providers (behavior analysts, special educators, speech pathologists, etc.) care for individuals with autism and how an interdisciplinary approach to patient care coordination can improve outcomes for patients. Understanding and incorporating elements of individualized educational and behavioral plans can assist nurses in providing safe, equitable and effective care. Presenters will use recent peer-reviewed research and case studies to highlight clinical best practices for caring for an autistic patient.

5:30 p.m.-6:30 p.m. | Executive Boardroom (3rd Floor)  
**Regional Leaders Meeting**

6:30 p.m.-8:00 p.m. | Narragansett Ballroom B (1st Floor)  
**Opening Reception, Exhibits, and Poster Session**  
*Sponsored by Children's Hospital of Philadelphia*  
(Poster presenters available for questions and discussion.)



8:00 p.m.-9:00 p.m.  
**Presidents' Circle** (By Invitation Only)

## Thursday, April 4, 2024

6:15 a.m.-7:15 a.m. | Kent Room (3rd Floor)  
**Yoga**  
Briana Snyder, PhD, RN, PMH-BC, CNE, RYT 200  
Towson University

7:30 a.m.-5:30 p.m. | Narragansett Ballroom Foyer (1st Floor)  
**Registration Open**

7:30 a.m.-8:30 a.m. | South County (3rd Floor)  
**ISPN New Member and Student Breakfast**  
All new members and students are welcome to attend!

7:30 a.m.-8:30 a.m. | Executive Boardroom (3rd Floor)  
**ISPN Foundation Meeting**

7:30 a.m.-8:30 a.m. | Narragansett Ballroom Foyer (1st Floor)  
**Continental Breakfast**  
*Sponsored by the American Academy of Nurse Practitioners Certification Board*



8:00 a.m.-6:00 p.m. | Rotunda (2nd Floor)  
**Relaxation Room**  
Open to all attendees - stop in anytime for a few quiet moments to decompress.

8:00 a.m.-6:00 p.m. | Stateside Suite (1st Floor)  
**Speaker Ready Room**



8:30 a.m.-9:30 a.m. | Narragansett Ballroom A (1st Floor)

### **Welcome and Opening Keynote** **The Delicate Connection: The Fine Art of Uncovering Suicidal Ideation**

Shawn Shea, MD  
Director, Training Institute for Suicide Assessment & Clinical Interviewing, Inc. (TISA)

9:30 a.m.-4:00 p.m. | Narragansett Ballroom B (1st Floor)  
**Exhibits Open**  
**Posters Available for Viewing**

9:40 a.m.-10:40 a.m. | Providence Ballroom II (3rd Floor)  
**Concurrent Session 1.1**  
**Pharmacogenomics (PGx) of Psychiatric Drug Metabolism: Phenotypes and Interactions of Six Cytochrome P450 (CYP) Enzyme Isoforms**  
David Newton, PhD, FAPhA  
Shenandoah University  
*Psychopharmacology & Integrative Health*

9:40 a.m.-10:40 a.m. | Providence Ballroom I (3rd Floor)  
**Concurrent Session 1.2**  
**Meeting the Mental Health and Substance Use Needs of Women Military Veterans with Substance Use-Related Issues**  
Brayden Kameg, DNP, PMHNP-BC, CARN-AP, CNE  
University of Pittsburgh School of Nursing  
*Evidence-Based Practice & Research*

9:40 a.m.-10:10 a.m. | Narragansett Ballroom A (1st Floor)  
**Concurrent Session 1.3**  
**Perseverance and Passion in Nursing Education**  
Heather Keperling, EdD, RN  
Alvernia University  
*Education/Teaching Pedagogy*

10:10 a.m.-10:40 a.m. | Narragansett Ballroom A (1st Floor)  
**Concurrent Session 1.4**  
**De 'CYFERing' Adversity: The Development of GRIT with the Next Generation of Health Care Providers**  
Dawn Bounds, PhD, PMHBP-BC, Sarah Rodrigues, PhD, RN, and Genesis Sanchez, BS  
University of California, Irvine  
*Education/Teaching Pedagogy*

10:40 a.m.-11:10 a.m. | Narragansett Ballroom B (1st Floor)  
**Refreshment Break and Visit with the Exhibitors**

11:10 a.m.-12:10 p.m. | Providence Ballroom II (3rd Floor)  
**Concurrent Session 2.1**  
**Management of Pediatric Patients Presenting with Acute Traumatic Physical Injuries in an Acute Care Hospital Setting: The Power of Interprofessional Collaboration, Integrative Approaches, and Holistic Healing**  
Taylor Flatt, MSN, CRNP, PMHNP-BC  
Children's Hospital of Philadelphia  
*Psychopharmacology & Integrative Health*

11:10 a.m.-12:10 p.m. | Providence Ballroom I (3rd Floor)

**Concurrent Session 2.2**

**ISPN Policy Activities for 2023-24**

Sally Raphael, MS, APRN-PMH, FAAN, Cynthia Handrup, DNP, APRN, PMHCNS-BC, FAAN, Brayden N. Kameg, DNP, PMHNP-BC, CARN, CNE, Elizabeth Bonham, PhD, RN, PMHCNS-BC, FAAN, Andrea Kwasky, DNP, PMHNP-BC, PMHCNS-BC, Barbara Peterson, PhD, PMHCNS-BC, APRN, and Mitch Kordzikowski, DNP, MBA, APRN, PMHNP-BC, NE-BC  
ISPN Policy Committee  
*Leadership Development*

11:10 a.m.-12:10 p.m. | Narragansett A (1st Floor)

**Concurrent Session 2.3**

**Equity Gaps in Substance Use Disorder Treatment: Uncovering Disparities and Pursuing Culturally Responsive Solutions for Communities of Color**

Tonjanika Ballard, DNP, PMHNP-C  
Unique Holistic Care, LLC  
*Education/Teaching Pedagogy*

12:10 p.m.-1:30 p.m.

**Lunch Break**



12:15 p.m.-1:15 p.m. | Narragansett Ballroom A (1st Floor)

**Product Theater Luncheon Sponsored by Neurocrine Biosciences**

Tardive Dyskinesia: Clinical Insights into Differential Diagnosis and Evidence-Based Treatment Strategies  
Daniel E. Wesemann, DNP, MSW, RN, APRN, PMHNP-BC, FAANP  
University of Iowa



1:30 p.m.-2:00 p.m. | Providence Ballroom II (3rd Floor)

**Concurrent Session 3.1**

**The Shared Trauma Professional Post Traumatic Growth Inventory for Mental Health Nurses: A Feasibility Study**

April Hutto, MSN, PMHNP-BC, FNP-BC, APRN  
Columbia Psychiatric Associates  
*Psychotherapy*

1:30 p.m.-2:00 p.m. | Providence Ballroom I (3rd Floor)

**Concurrent Session 3.2**

**Counseling Specialization Students' Perspectives on Integrating Cognitive Behavioral Therapy at the Universal Tier into School-based Mental Health Services: A Content Analysis**

Cristina Lu, MSN, RN-BC  
Caldwell University  
*Evidence-Based Practice & Research*

1:30 p.m.-2:00 p.m. | Narragansett Ballroom A (1st Floor)

**Concurrent Session 3.3**

**Fostering Lifelong Learning: The Role of Critical Reflection in Shaping PMHNP Student Development**

Sara Robinson, DNP, RN, PMHNP-BC  
University of New Hampshire  
*Education/Teaching Pedagogy*

2:00 p.m.-2:30 p.m. | Providence Ballroom I (3rd Floor)

**Concurrent Session 3.4**

**Implementing a Holistic, Student-centered Coaching Program in Prelicensure Nursing Education: A Case Study Review to Assist Future Healers and Leaders**

Sara Gifford, DNP, RN, AGCNS-BC  
University of Detroit, Mercy, McAuley School of Nursing  
*Education/Teaching Pedagogy*

2:00 p.m.-2:30 p.m. | Providence Ballroom II (3rd Floor)

**Concurrent Session 3.5**

**Promoting Health Equity by Reducing Violence in Behavioral Health Units**

Marchè Holt, DNP, RN  
Samford University  
*Evidence-Based Practice & Research*

2:00 p.m.-2:30 p.m. | Narragansett Ballroom A (1st Floor)

**Concurrent Session 3.6**

**Meeting the Rural Health Challenge: Academic and Clinical Partnerships in Rural Mental Health**

Barbara Peterson, PhD, PMHCNS, APRN  
University of Minnesota  
*Education/Teaching Pedagogy*

2:30 p.m.-3:00 p.m. | Narragansett Ballroom B (1st Floor)

**Refreshment Break**

2:30 p.m.-3:00 p.m. | South County (3rd Floor)

**IMIN Meet and Greet**

The *ISPN Mentoring Initiative Navigator Program*, or *IMIN*, is a capacity building project started in 2014 and sponsored by the ISPN Membership Committee. The IMIN model was designed with two aims: 1) to increase an involved membership in ISPN by connecting new members with seasoned ISPN members; and 2) to facilitate leadership succession planning by mentoring members into leadership positions within the organization. Find out more by attending the IMIN Meet and Greet -- whether you are a mentor, mentee, or new to the program.

3:00 p.m.-4:00 p.m. | Narragansett Ballroom A (1st Floor)

**Concurrent Session 4.1**

**Components of Emerging Practice Models for the Management of Acute Psychiatric Emergencies**

Lyndon J. Taylor, RN, PHN, BSN  
University of Missouri  
*Leadership Development*

3:00 p.m.-3:30 p.m. | Providence Ballroom II (3rd Floor)

**Concurrent Session 4.2**

**Depression Trajectories Among Women with T2D: A Diagnostic-Agnostic Approach to Characterizing Depressive Symptom Profiles Over Five Years**

Nicole Perez, PhD, RN, PMHNP-BC  
New York University  
*Evidence-Based Practice & Research*

3:00 p.m.-4:00 p.m. | Providence Ballroom I (3rd Floor)

**Concurrent Session 4.3**

**Fading into the Background: The Overlooked Struggle of Women and Girls with ADHD**

Tonjanika Ballard, DNP, PMHNP-C  
Unique Holistic Care, LLC  
*Education/Teaching Pedagogy*

3:30 p.m.-4:00 p.m. | Providence Ballroom II (3rd Floor)

**Concurrent Session 4.4**

**Nurses Supporting Nurses: Assessment of Hospital-based Nurse Well-being**

Frankie Hale, PhD, RN  
University of Hawaii, Manoa  
*Evidence-Based Practice & Research*



4:10 p.m.-5:10 p.m. | Narragansett Ballroom A (1st Floor)

**Diversity Award Plenary Lecture Promoting Health Justice Among Immigrants and Refugees in Iowa**

Emily Sinnwell, DNP, ARNP, FNP-BC, PMHNP-BC

Clinical Assistant Professor, University of Iowa College of Nursing

5:20 p.m.-5:50 p.m. | Narragansett Ballroom A (1st Floor)

**Concurrent Session 5.1**

**"Our Stories Are Our Way-Makers": Restoration of Hope and Self-efficacy Through Community Mediated Psychoeducation**

Kimberly McClellan, EdD, MSN, FNP-BC, WHNP-BC  
Johns Hopkins University  
*Evidence-Based Practice & Research*

5:20 p.m.-6:20 p.m. | Providence Ballroom II (3rd Floor)

**Concurrent Session 5.2**

**Archives: Update on the ISPN Society Journal**

Edilma Yearwood, PhD, PMHCNS-BC, FAAN<sup>1</sup>, Cynthia Taylor Handrup, DNP, APRN, PMHCNS-BC, FAAN<sup>2</sup>, Sally Raphael, MSN, RN, FAAN

<sup>1</sup>Georgetown University School of Nursing, <sup>2</sup>University of Illinois, Chicago

*Evidence-Based Practice & Research*

5:20 p.m.-5:50 p.m. | Providence Ballroom I (3rd Floor)

**Concurrent Session 5.3**

**Preparing the Next Generation of Nurses Through an Unfolding Undergraduate Psychiatric Simulation**

Jennifer Graber, EdD, PMHCNS-BC and Caren Coffy-McCormick, DNP, PMHCNS-BC  
University of Delaware  
*Education/Teaching Pedagogy*

5:50 p.m.-6:20 p.m. | Narragansett Ballroom A (1st Floor)

**Concurrent Session 5.4**

**Luna Mental Health Virtual Coach: Enhancing Student Resilience and Well-being Through Innovative AI-Based Chatbot**

Phillip Ola, PhD<sup>1</sup> and Ashlee Barnes, DNP, APRN, FNP-C<sup>2</sup>  
<sup>1</sup>University of Detroit, Mercy and <sup>2</sup>McAuley School of Nursing  
*Education/Teaching Pedagogy*

5:50 p.m.-6:20 p.m. | Providence Ballroom I (3rd Floor)

**Concurrent Session 5.5**

**Moral Distress, Courage, and Resilience: Teaching Undergraduate Nursing Students How to Apply These Concepts to Ethical Inquiry and Future Nursing Practice**

Cynthia P. Paidipati, PhD, APRN, PMH-NP/CNS-BC  
Loyola University Chicago  
*Education/Teaching Pedagogy*

7:00 p.m.-9:00 p.m. | Waterplace Ballroom I (2nd Floor)

**ISPN Foundation Reception: Healing Through Connection**

(available at an additional fee)  
Standard Ticket: \$100 | Student Ticket \$50  
*Limited tickets will be available at the meeting.*

Proceeds fund research, wellness, and travel grants for psychiatric mental health nurses and the ISPN historical archives. We welcome everyone to join us for a nice meal, socializing, and finding some treasures and/or experiences!

Purchase tickets at [ispn-psych.org/2024-registration](https://ispn-psych.org/2024-registration) or email [info@ispn-psych.org](mailto:info@ispn-psych.org).

The ISPN Foundation Board is always looking for donated items to be placed in the auction, especially experiences! To find out more, visit [ispn-psych.org/2024-foundation-event](https://ispn-psych.org/2024-foundation-event).



**Friday, April 5, 2024**

6:00 a.m.-7:00 a.m. | Kent Room (3rd Floor)

**Yoga**

Briana Snyder, PhD, RN, PMH-BC, CNE, RYT 200  
Towson University



7:15 a.m.-8:15 a.m. | Narragansett Ballroom A (1st Floor)

**Product Theater Breakfast Sponsored by Karuna Therapeutics**

Rethink Schizophrenia  
Desiree Matthews, PMHNP-BC  
Different MPH



8:00 a.m.-5:30 p.m. | Narragansett Ballroom Foyer (1st Floor)  
**Registration Open**

8:00 a.m.-6:00 p.m. | Rotunda (2nd Floor)

**Relaxation Room**

Open to all attendees - stop in anytime for a few quiet moments to decompress.

8:00 a.m.-6:00 p.m. | Stateside Suite (1st Floor)

**Speaker Ready Room**



8:30 a.m.-9:30 a.m. | Narragansett Ballroom A (1st Floor)

**Melva Jo Hendrix Lectureship**

**Public Thought Leadership:**

**Why Your Voice Matters**

Mona Shattell, PhD, RN, FAAN

Chair and Professor, Department of Nursing Systems, Hugh F. and Jeannette G. McKean Endowed Chair, College of Nursing, University of Central Florida

9:30 a.m.-4:00 p.m. | Narragansett Ballroom B (1st Floor)

**Exhibits Open**

**Posters Available for Viewing**

9:40 a.m.-10:40 a.m. | Providence Ballroom II (3rd Floor)

**Concurrent Session 6.1**

**Stimulant Bootcamp: Pharmacodynamics, Pharmacokinetics, and How to Maximize Effectiveness without Continuously Increasing Dosages**

Ann Marie Jones, DNP, PMHNP-BC

University of North Carolina, Chapel Hill

*Psychopharmacology & Integrative Health*

9:40 a.m.-10:10 a.m. | Providence Ballroom I (3rd Floor)

**Concurrent Session 6.2**

**Addressing Systemic Racism and Generational Anxiety Using Bowenian Family Therapy on African American Populations: A Discursive Review**

Nia Josiah, DNP, PMHNP

Columbia University

*Psychotherapy*

9:40 a.m.-10:10 a.m. | Narragansett Ballroom A (1st Floor)

**Concurrent Session 6.3**

**Advanced Practice Registered Nurses as Leaders in Crisis Intervention: My Experience with 988 Suicide and Crisis Lifeline**

Susan Glodstein, DNP, RN, PMHNP-BC, PMHCNS-BC

Binghamton University

*Education/Teaching Pedagogy*

10:10 a.m.-10:40 a.m. | Narragansett Ballroom A (1st Floor)

**Concurrent Session 6.4**

**Leading the Adoption of a Nurse-Driven Screening Tool to Mitigate Patient Violence**

David Karcher, PMHCNS-BC, NEA-BC, PMHRN-BC and Rinka

Shiraishi, MSN, RN, SCRNP

Cedars-Sinai Health System

*Education/Teaching Pedagogy*

10:10 a.m.-10:40 a.m. | Providence Ballroom I (3rd Floor)

**Concurrent Session 6.5**

**Psychosocio-Economic Determinants of Suicide on a Global Perspective**

Endrex Nemenzo, MSN, MBA, RN

Cebu Normal University, Philippines and SHL Medical, Taiwan

*Education/Teaching Pedagogy*

10:40 a.m.-11:10 a.m. | Narragansett Ballroom B (1st Floor)

**Refreshment Break**

10:40 a.m.-11:10 a.m. | Newport Room (3rd Floor)

**International Attendee Meet and Greet**

Are you attending the ISPN Annual Conference from outside of the U.S.? If so, you are invited to the International Meet and Greet! Meet Board members and network with other colleagues.

11:10 a.m.-12:10 p.m. | Providence Ballroom II (3rd Floor)

**Concurrent Session 7.1**

**Compassion Fatigue Among Psychiatric Mental Health:**

**Advanced Practice Psychiatric Nurses**

Maria Eden Gianan, DNP, PMH-CNS, APN-BC

Edith Nourse Veterans Memorial Hospital

*Evidence-Based Practice & Research*

11:10 a.m.-11:40 a.m. | Providence Ballroom I (3rd Floor)

**Concurrent Session 7.2**

**Advancing Civic Engagement Among Psychiatric Mental-Health Nurses**

Carrie Rewakowski, PhD, RN, NPD-BC, CNE

Le Moyne College

*Leadership Development*

11:10 a.m.-12:10 p.m. | Narragansett Ballroom A (1st Floor)

**Concurrent Session 7.3**

**Utilization of Trauma Informed Care in Daily Practice**

Patrice Wade-Olson, DNP, AGPCNP-BC, AAHIV

Corktown Health Center and University of Detroit, Mercy

*Education/Teaching Pedagogy*

11:40 a.m.-12:10 p.m. | Providence Ballroom I (3rd Floor)

**Concurrent Session 7.4**

**Navigating Closure: The Art and Science of Termination in Client-Provider Relationships**

Mitchell Kordzikowski, DNP, MBA, APRN, PMHNP-BC, NE-BC

and Cynthia Handrup, DNP, APRN, PMHCNS-BC, FAAN

University of Illinois, Chicago, College of Nursing

*Psychotherapy*

12:10 p.m.-1:30 p.m.

**Lunch Break**



12:15 p.m.-1:15 p.m. | Narragansett Ballroom A (1st Floor)

**Product Theater Luncheon Sponsored by Neurocrine Biosciences**

The Impact of Tardive Dyskinesia:

The Data and a Patient Story

Amy LaCouture, RN, APRN, PMHNP-BC

Synergy Behavioral Health LLC



Bethany

Patient Ambassador

Amy LaCouture will present the burden and impact of tardive dyskinesia and Patient Ambassador Bethany, will talk about her journey so that the audience can understand the impact of tardive dyskinesia on her life.



1:30 p.m.-3:00 p.m. | Narragansett Ballroom A (1st Floor)  
**ISPN Business Meeting and Awards Ceremony**

3:00 p.m.-3:30 p.m. | Narragansett Ballroom B (1st Floor)  
**Refreshment Break – Last Time to Visit the Exhibitors and View the Posters**

3:30 p.m.-4:30 p.m. | Providence Ballroom II (3rd Floor)  
**Concurrent Session 8.1**  
**Somatic Nursing: A Neuroscience Approach to Treating Mental Health Disorders and Conditions**  
Emily Knife, RN, MSN-Edu, YT-500, MT  
Emory University School of Nursing  
*Psychotherapy*

3:30 p.m.-4:00 p.m. | Providence Ballroom I (3rd Floor)  
**Concurrent Session 8.2**  
**An Opioid Overdose Prevention Session: Improving BSN Student Knowledge and Confidence in the Management of Opioid Use and Implementation of Harm Reduction Strategies**  
Brayden Kameg, DNP, PMHNP-BC, CARN-AP, CNE and Ann Mitchell, PhD, RN  
<sup>1</sup>University of Pittsburgh School of Nursing  
*Education/Teaching Pedagogy*

3:30 p.m.-5:00 p.m. | Narragansett Ballroom A (1st Floor)  
**Workshop 1: Empowering Healthcare Worker Safety: A Call to Action for Urgently Needed Policy Reform and the Adoption of Effective Mitigation Strategies**  
Jim J. Kane, MN, RN, CNS, NEA-BC<sup>1</sup>, Brayden Kameg, DNP, PMHNP-BC, CARN-AP, CNE<sup>2</sup>, David Karcher, MSN, PMH CNS-BC, NEA-BC, PMHRN-BC<sup>3</sup>, Mitch Kordzikowski, DNP, MBA, APRN, PMHNP-BC, PMH-BC, NE-BC<sup>4</sup>, Pamela Minarik, PhD, RN, CNS, FAAN<sup>5</sup>, Karen Ragaisis, DNP, PMHNP-BC, PMHCNS-BC, CARN-AP<sup>6</sup>, Sally Raphael, MS, APRN-PMH, FAAN<sup>7</sup>, and Elizabeth Steinmiller, MSN, PMHCNS-BC<sup>8</sup>  
<sup>1</sup>University of California, San Diego, <sup>2</sup>University of Pittsburgh School of Nursing, <sup>3</sup>Cedars Sinai Medical Center, <sup>4</sup>University of Illinois, Chicago, College of Nursing, <sup>5</sup>Samuel Merritt University, <sup>6</sup>Quinnipiac University, University, <sup>7</sup>Retired, and <sup>8</sup>Children's Hospital of Philadelphia  
*Leadership Development*

4:00 p.m.-4:30 p.m. | Providence Ballroom I (3rd Floor)  
**Concurrent Session 8.3**  
**Utilizing Artificial Intelligence Technology to Promote Online Student Engagement**  
Lee Hardin, DNP, MBA, RN, NE-BC, CNE, COI, Sherri Chatman, and Stephanie Wynn, DNP, RN-BC, PMHNP-BC, FNP-BC, FAANP, FNAP  
Samford University  
*Education/Teaching Pedagogy*

4:40 p.m.-5:40 p.m. | Providence Ballroom II (3rd Floor)  
**Concurrent Session 9.1**  
**Gender-sensitive Therapeutic Use of Self in Trauma Informed Care: How Hard Can it Be?**  
Emily Hauenstein, PhD, LCP, MSN, FAAN  
University of Virginia School of Nursing  
*Psychotherapy*

4:40 p.m.-5:40 p.m. | Providence Ballroom I (3rd Floor)  
**Concurrent Session 9.2**  
**Empowering Black Mental Wellness: Unveiling Disparities, Charting Pathways to Change**  
Kirby Williams, MSN, PMHNP-BC  
Beacon Behavioral Health and Consulting, LLC and The PMHNP Source, LLC  
*Evidence-Based Practice & Research*

5:10 p.m.-5:40 p.m. | Narragansett Ballroom A (1st Floor)  
**Concurrent Session 9.3**  
**Educating Undergraduate Nursing Students to Be Leaders in Suicide Prevention Through QPR Gatekeeper Training**  
Robi Thomas, PhD, RN, PMHNP-BC and Andrea Kwasky, DNP, PMHNP-BC, PMHCNS-BC  
University of Detroit, Mercy  
*Education/Teaching Pedagogy*

5:50 p.m.-6:20 p.m. | Providence Ballroom I (3rd Floor)  
**Concurrent Session 10.2**  
**Promoting a Culture of Openness and Support in Law Enforcement**  
Karan Kverno, PhD, PMHNP-BC, PMHCNS-BC, FAANP, FAAN<sup>1</sup> and Julia Kaye Knauff, DNP, FNP-BC, PMHNP-BC<sup>2</sup>  
<sup>1</sup>Georgetown University School of Nursing and <sup>2</sup>First Responder Peer Support Network  
*Evidence-Based Practice & Research*

5:50 p.m.-6:20 p.m. | Narragansett Ballroom A (1st Floor)  
**Concurrent Session 10.3**  
**Development and Implementation of a Suicide Prevention Curriculum within a University Setting**  
Caroline McKinnon, PhD, PMHCNS-BC  
Augusta University  
*Education/Teaching Pedagogy*

6:30 p.m.-7:30 p.m. | Narragansett Ballroom A (1st Floor)  
**Regional Meetings**  
Planning to attend the Regional Meetings starting at 6:30 PM? All attendees are welcome! If you don't know your region, greeters will be there to direct you to the right tables.

6:30 p.m.-7:30 p.m. | Executive Boardroom (3rd Floor)  
**Archives of Psychiatric Nursing Journal Editorial Board Meeting**

7:30 p.m.-9:00 p.m. | South County Room (3rd Floor)  
**Student Event**  
All students are invited to attend!



7:00 a.m.-8:00 a.m. | Kent Room (3rd Floor)

**Yoga**

Briana Snyder, PhD, RN, PMH-BC, CNE, RYT 200  
Towson University

8:00 a.m.-12:00 p.m. | Narragansett Ballroom Foyer (1st Floor)

**Registration Open**

8:00 a.m.-11:00 a.m. | Stateside Suite (1st Floor)

**Speaker Ready Room**

8:00 a.m.-11:00 a.m. | Rotunda (2nd Floor)

**Relaxation Room**

Open to all attendees - stop in anytime for a few quiet moments to decompress.

8:00 a.m.-9:00 a.m. | Narragansett Ballroom Foyer (1st Floor)

**Continental Breakfast**

8:30 a.m.-9:30 a.m. | Providence Ballroom II (3rd Floor)

**Concurrent Session 11.1**

**The Essential Triad of Nurse-Patient-Interpreter Relationship to Optimal Therapeutic Outcomes**

Marian Newton, PhD, PMHNP-BC, PMHCNS-BC, ANEF<sup>1</sup> and Karen Goyette Pounds, PhD, PMHCNS-BC<sup>2</sup>  
<sup>1</sup>Shenandoah University, <sup>2</sup>Boston College  
*Psychotherapy*

8:30 a.m.-9:30 a.m. | Narragansett Ballroom A (1st Floor)

**Concurrent Session 11.3**

**The Planet as My Patient: Mental Health Advocacy on a Global Scale at the United Nations: Bringing the Voice and Expertise of Nurses to the United Nations System**

Holly Shaw, PhD, RN  
University of Minnesota School of Nursing and Long Island University  
*Leadership Development*

9:40 a.m.-10:10 a.m. | Providence Ballroom I (3rd Floor)

**Concurrent Session 12.1**

**Using Comorbidity Cases to Strengthen Collaborative Care in PMHNP Nursing Education**

Marci Zsamboky, DNP, PMHNP-BC, CNE and Lori Dado, DNP, FNP-BC, PMHNP-BC  
Duquesne University School of Nursing  
*Education/Teaching Pedagogy*

9:40 a.m.-10:10 a.m. | Providence Ballroom II (3rd Floor)

**Concurrent Session 12.2**

**When is Depression Really Bipolar II Disorder?**

Caren Coffy-McCormick, DNP, APRN, PMHCNS-BC and Jennifer Graber, EdD, APRN, PMHCNS-BS  
University of Delaware  
*Psychopharmacology & Integrative Health*

9:40 a.m.-10:10 a.m. | Narragansett Ballroom A (1st Floor)

**Concurrent Session 12.3**

**Health Equity Research Bootcamp Using Collaborative Community Resources**

Mary Louse Tatum, MPH, MSN, PMHNP-BC, MNP-BC  
Cleveland Clinic  
*Leadership Development*

10:20 a.m.-10:50 a.m. | Providence Ballroom I (3rd Floor)

**Concurrent Session 13.1**

**The Community Psychiatric Nurse Practitioner: A Model for Workforce Development: The VNS Health Community Psychiatry Nurse Practitioner Fellowship**

Rachel Griffin, DNP, MPH, PMHNP-BC<sup>1</sup> and Andrea Abranoff, MSN, PMHNP-BC<sup>1</sup>  
<sup>1</sup>Visiting Nurse Services of New York and <sup>2</sup>Columbia University  
*Leadership Development*

10:20 a.m.-11:20 a.m. | Providence Ballroom II (3rd Floor)

**Concurrent Session 13.2**

**Research Using the ISPN Historical Archives**

Catherine Kane, PhD, RN, FAAN, Professor Emerita and Julie Roebuck, DNP, PMHNP-BC  
University of Virginia School of Nursing  
*Evidence-Based Practice & Research*

10:20 a.m.-10:50 a.m. | Narragansett Ballroom A (1st Floor)

**Concurrent Session 13.3**

**Keep Calm and Teach On! Personality Disorders and Simulated Group Therapy Session**

Jennifer Graber, EdD, PMHCNS-BC and Christine Hanna-Ronald, MSN, PMHNP-BC  
University of Delaware  
*Education/Teaching Pedagogy*

11:20 a.m.-11:50 a.m. | Narragansett Ballroom Foyer (1st Floor)

**Refreshments and Snacks**

11:50 a.m.-12:50 p.m. | Providence Ballroom I (3rd Floor)

**Concurrent Session 14.1**

**Diagnosis of Borderline Personality Disorder in Adolescents (BPD-A): A Rapid Review with Recommendations for Practice and Future Research**

Maricar Bana, BSN, RN, CNRN, HNB-BC  
University of Florida  
*Evidence-Based Practice & Research*



11:50 a.m.-12:50 p.m. | Narragansett Ballroom A (1st Floor)

### Concurrent Session 14.2

#### **No Room in the Curriculum: Considerations for Educating Advanced Practice Psychiatric Nurses to Provide Care for Neurodiverse Populations**

Holly E. Brown, DNP, RN, PMHNP-BC, PMHCS and Janiece DeSocio, PhD, RN, PMHNP-BC, FAAN  
Golisano Institute for Developmental Disability Nursing/St. John Fisher University  
*Education/Teaching Pedagogy*

11:50 a.m.-12:50 p.m. | Providence Ballroom II (3rd Floor)

### Concurrent Session 14.3

#### **Violence Against Nurses in the Workplace: We Need to Act NOW!**

Emily Hauenstein, PhD, LCP, RN, MSN, FAAN<sup>1</sup>, Kathleen R. Delaney, PhD, APRN, PMH-NP, FAAN<sup>4</sup>, Joanne DeSanto Iennaco, PhD, APRN, PMHNP-BC, FAAN, FFMRCIS<sup>2</sup>, and Mona Shattell, PhD, RN, FAAN<sup>3</sup>  
<sup>1</sup>University of Virginia, School of Nursing, <sup>2</sup>Yale University School of Nursing, <sup>3</sup>University of Central Florida, and <sup>4</sup>Rush College of Nursing



1:00 p.m.-2:00 p.m. | Narragansett Ballroom A (1st Floor)

#### **Susan McCabe Lecture and Closing Keynote You Can't Punish the Pain Out of People: A Toolkit for Practicing Radical Empathy**

Kimberly Dion, RN, PhD, CNE, CARN, FIAAN  
Clinical Professor, Elaine Marieb College of Nursing, University of Massachusetts Amherst

2:30 p.m.-3:30 p.m. | Executive Boardroom (3rd Floor)

#### **ISPN Committee Chairs Meet with the Board of Directors (Lunch provided)**

Committee Chairs are invited to attend this portion of the Board meeting.

3:30 p.m.-5:00 p.m. | Executive Boardroom (3rd Floor)

#### **ISPN Board of Directors Meeting**



## Poster Session

Narragansett Ballroom B (1st Floor)

### Poster Set-up

Wednesday, April 3 from 5:30 p.m.-6:30 p.m.

### Presentation Dates and Times

Wednesday, April 3 from 6:30 p.m.-8:00 p.m. (authors present)

Thursday, April 4 from 9:30 a.m.-4:00 p.m.

Friday, April 5 from 9:30 a.m.-3:30 p.m.

### Poster Teardown Time

Friday, April 5 from 3:30 p.m.-4:00 p.m.

Poster 1

#### **Nursing Students' Response to Mindfulness Interventions: An Innovative Mental and Physical Educational Preparedness**

Ashlee Barnes, DNP, APRN, FNP-C and Arthur Ko, PhD, RN  
University of Detroit, Mercy  
*Education/Teaching Pedagogy*

Poster 2

#### **Scoping Review: Debriefing Types in Health Science Simulations**

Claire Song, BScPN, RPN, MSc  
Douglas College  
*Education/Teaching Pedagogy*

Poster 3

#### **A Pilot Study Integrating Simulation into a Psychiatric Mental Health Nurse Practitioner Program**

Rebecca Schroeder, DNP, MPH, PMHNP  
University of Maine  
*Education/Teaching Pedagogy*

Poster 4

#### **Metabolic Monitoring of Pediatric Patients Prescribed Second-generation Antipsychotic Medication**

Julie Roebuck, MSN, DNP, PMHNP-BC  
University of Virginia  
*Education/Teaching Pedagogy*

Poster 5

#### **Trauma's Far Reach**

Patrice Wade-Olson, DNP, AGPCNP-BC, AAHIV<sup>1</sup> and Arthur Ko, PhD, RN<sup>2</sup>

<sup>1</sup>Corktown Health Center and University of Detroit, Mercy,

<sup>2</sup>University of Detroit, Mercy

*Evidence-Based Practice & Research*

Poster 6

#### **Atypical Antipsychotics: Preventing and Mitigating Weight Gain**

Nick Dotson, DNP, APRN, PMHNP-BC, MSTOM, LAc  
and Cynthia Handrup, DNP, APRN, PMHCNS-BC, FAAN  
University of Illinois, Chicago  
*Psychopharmacology & Integrative Health*



Poster 7  
**Mental Health Outcomes of Poor Access to Healthcare as it Relates to Pelvic Floor Dysfunction in Native American Women**  
Lexxie Gramke, PhD, PMHNP-BC, AGPCNP-BC  
University of Illinois, Chicago  
*Evidence-Based Practice & Research*

Poster 8  
**Nurse Leaders Strategies to Enhance Wellbeing for their Teams**  
Mamilda Robinson, DNP, APN, PMHNP-BC  
Rutgers University School of Nursing  
*Leadership Development*

Student Poster 9  
**Using Cognitive-Behavioral Therapy in the COPE Program to Reduce Anxiety and Depression: Group Therapy in a School Setting**  
Meg Tomlins, MPH, RN  
University of Illinois, Chicago  
*Evidence-Based Practice & Research*

Poster 10  
**Population Mental Health: Mental Health Literacy Education for Youth Sports Coaches**  
Donald Taylor, MS, RN, PMHNP-BC  
Oregon Health & Sciences University  
*Evidence-Based Practice & Research*

Poster 11  
**Effectiveness of Mental Health First Aid as a Supportive Tactic on Resilience and Organizational Environment-Related Factors Among Nurses in the Wake of COVID-19: The Search Continues**  
Rasha Eweida, PhD, MSc, BSN  
Collège of Health and Sport Sciences, Bahrain  
*Evidence-Based Practice & Research*

Poster 13  
**Enhancing Maximal Response to Antidepressants with Patient-Centered Care: A Continuing Education Initiative**  
Robert Lowney, MBA  
CMEology  
*Education/Teaching Pedagogy*

Student Poster 15  
**Reducing Nurse Burnout and Sentinel Events on an Inpatient Psychiatric Unit Using a Psychiatric Acuity Tool**  
Ilana Abramowitz, RN, MSN  
University of Maryland, Baltimore  
*Leadership Development*

Student Poster 16  
**Disruptive Clinician Behavior: A Qualitative Descriptive Study of Non-native English-speaking Nurses**  
Seyoung Baik and Julie Bertram, PhD  
University of Missouri, St Louis  
*Leadership Development*

Student Poster 17  
**Physical Violence Reduction Towards Staff in a Large Intercity Inpatient Psychiatric Unit**  
Lawrencia Addo Darko, RN, BSN  
University of Maryland, Baltimore, School of Nursing  
*Evidence-Based Practice & Research*

Student Poster 18  
**Unveiling the Invisible Wounds: Exploring Racial Trauma Through Evidence-Based Assessments**  
Christopher E. O'Brien, DNP(c), MSN, RN and  
Cynthia Handrup, DNP, APRN, PMHCNS-BC, FAAN  
University of Illinois, Chicago  
*Evidence-Based Practice & Research*

Poster 19  
**Enhancing the Capacity for Mental Health Research and Care in Cambodia: A Phenomenological Study**  
Julie Bertram, PhD  
University of Missouri, St. Louis  
*Evidence-Based Practice & Research*



## EXPLORE PSYCHIATRIC NURSE PRACTITIONER ROLES AT **Children's Hospital of Philadelphia**

Become a **Breakthrough Maker** at our new **Behavioral Health and Crisis Center**. Located in Philadelphia, PA, this center is a 24/7 walk-in facility that evaluates children 5 to 17 years old with immediate mental health needs and provides short-term therapy.



**IDgenetix**  
▶ PGx Testing

## Go from trial and error **to test and treat**

Advanced pharmacogenomic (PGx) testing that guides personalized mental health medication selection, tailored to each patient's unique profile.

**Stop by the Castle table to learn more!**

**C/STLE**  
BIOSCIENCES  
CBC-0117v1-032024



**BEST HOSPITALS**  
AS RATED BY  
**USNEWS**  
PSYCHIATRY  
2023-2024

## GREAT NURSES NEVER STOP LEARNING

Are you taking advantage of our free education programs? McLean offers a wide range of webinars, courses, and trainings to help nurses like you enhance their knowledge and grow their careers. Sign up for one today!

[mclean.org/learning](https://mclean.org/learning)

## Deconstructing Stigma

*Presented by McLean Hospital*



**COMPREHENSIVE CARE FOR THE COMPLICATED DISEASE OF ADDICTION, CO-OCCURRING MENTAL HEALTH, AND PRIMARY MENTAL HEALTH CONDITIONS**



**855.HOPE.300 | 24 Hour Admissions**

[www.futuresrecoveryhealthcare.com](http://www.futuresrecoveryhealthcare.com)



**ISP**

**International Society of  
Psychiatric-Mental Health Nurses**

**Email: [info@ispn-psych.org](mailto:info@ispn-psych.org)**

**Website: [ispn-psych.org](http://ispn-psych.org)**

